

## Smart Sensor Layout

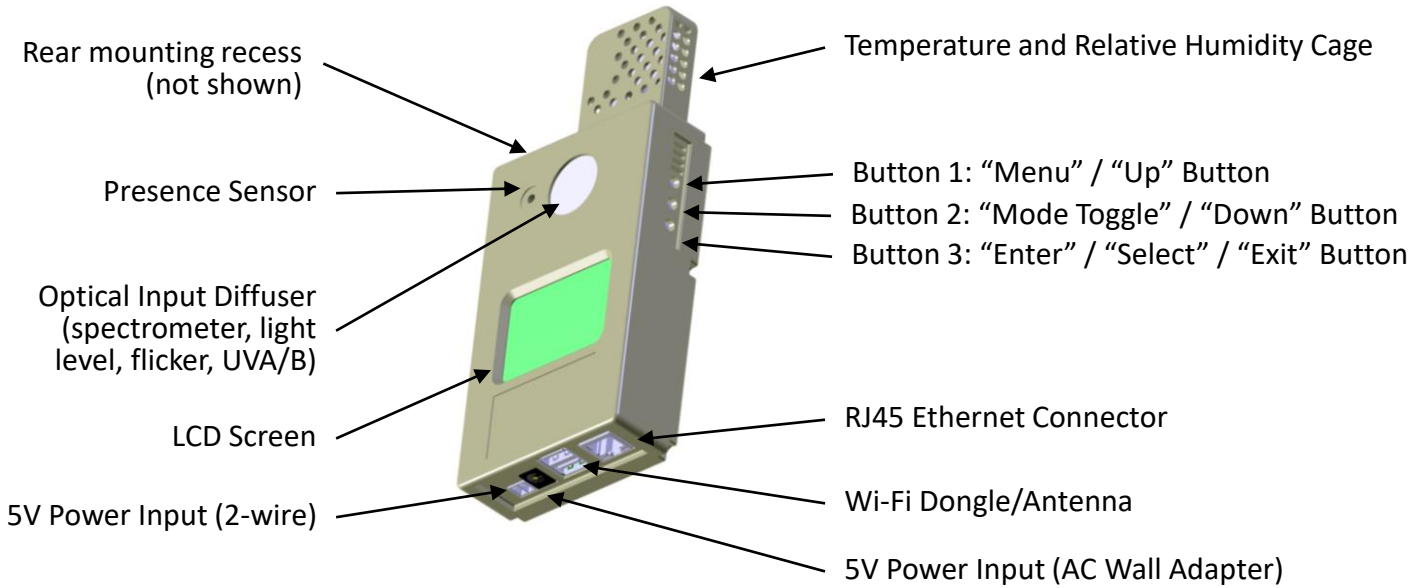

### Start Here

Download "LMIOT ReadMe First" and "LMIOT User Guide" from <https://landminstruments.com/support/>

1.



#### Attach Network Cable to RJ45 Ethernet Connector (for Wired-Ethernet installations)

- This will allow immediate network detection as part of Step 2 below.
- Wi-Fi installations will be configured below.

2.



#### Apply Power

- Connect the [included] AC Wall Adapter to wall power (110-230, 50-60Hz) and the 5V Power Input (AC Wall Adapter) input. Note the unit will take approximately 20 seconds to boot.
- Screen will display "Waiting for Network" while looking for network. Note that the network will not be found during initial power up of Wi-Fi installations.



**See Wi-Fi Configuration on next page for Wi-Fi installations**

3.



#### Access Telemetry Data and Analytics!

- Access the Web App via the URL provided by L&M Instruments.



## Wi-Fi Configuration

**Note: Start at “Start Here” on opposite side / previous page.**

Wi-Fi can be configured from the Continuous Monitoring Web Application (via computer, smart phone or tablet) or, on some devices, via the device itself.

### Wi-Fi Configuration via App

1. Connect the LMIoT device to the internet with a hard-wired Ethernet LAN connection.
2. From a web browser, smart phone, or tablet select the device from the Device Select menu (the device selection will match the label on the rear of the unit).
3. Enter the Settings menu (sometimes requiring a scroll down of the menu on smaller devices) and under Device Settings enter the WiFi SSID and Password fields followed by Set SSID and PW.
4. Wait 10 seconds before removing wired connection and testing Wi-Fi connectivity via either Internet LED or, on some models, antenna icon on LCD.

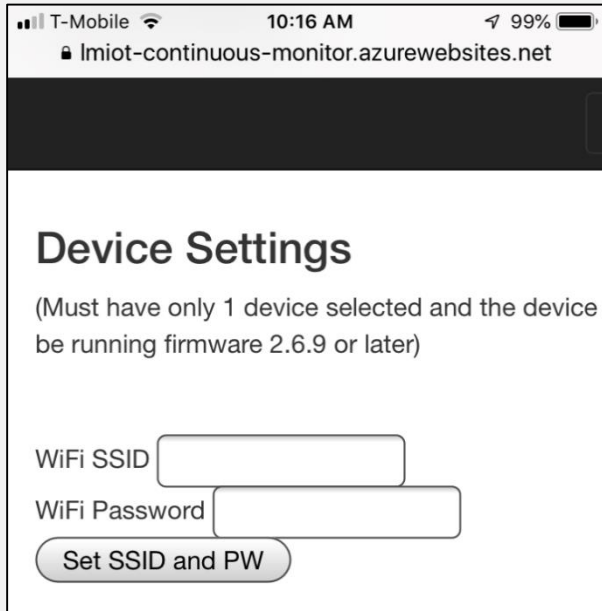

### Wi-Fi Configuration via Device

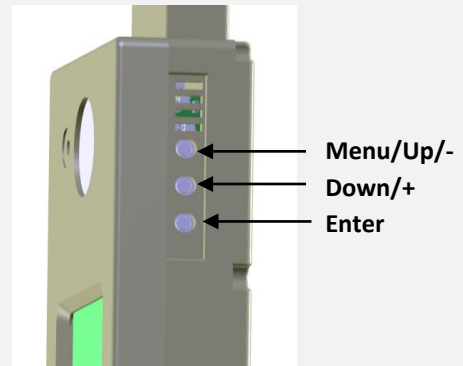

1. After the “Waiting for Network...” screen disappears and the LCD screen displays sensor data, press and hold the top “Menu” button to enter the main menu.
2. Use the “Up”, “Down”, and “Enter” buttons on the right of the unit to select the “Setup WiFi” menu item.
3. Follow the prompts to either “Scan Networks” or “Set SSID/PW” [Manually].
4. For text field inputs the “-” and “+” buttons on the right of the unit to scroll through available characters and press the “Enter” button to select a character. Selecting “abc”, “ABC”, “123” will bring up the different character sets (“123” includes symbols). “< - -” is backspace. “ESC” aborts the process. **“DONE” accepts the input and starts the network authentication process.**
5. Once complete < - - Back out of all menus.